



**SA Genealogy &  
Heraldry  
Society Inc**

**Library  
201 Unley Road  
Unley SA**

**FACT  
SHEET**

# Start up

This sheet outlines the locations in the library of the records useful as a starting point for family history research.

The key is on the back of this sheet.

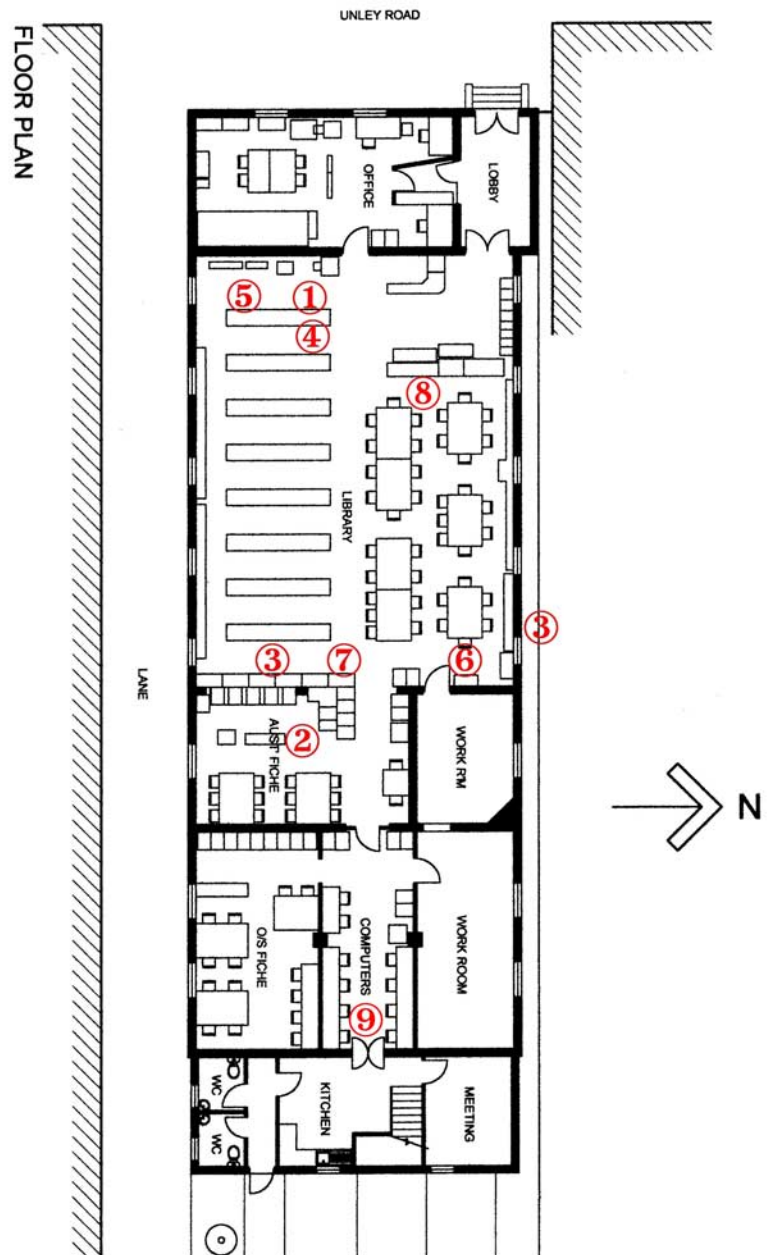

## **Biographical Index of South Australians**

*Biographical Index of South Australians 1836–1885* (known as BISA, 4 green books), together with *South Australians 1836–1885* (2 green books). Check what you find as they were published before the Society had access to the BDM District Records and the new BDM Indexes to Registrations. See location ①

## **BDM Indexes**

Births 1842–1922, Marriages 1842–1937, and Deaths 1842–1970

The easiest way to search these is on the computer as this allows searches by given name, maiden name, date, etc; otherwise they are available in book form on the shelves beneath the BISA books at location ① or fiche at location ②

## **BDM District Records**

Births 1842–1922, Marriages 1842–1937, and Deaths 1842–1970 (microfiche)

These are *duplicates* of the official Birth, Death and Marriage certificates. However there are some certificates in the District Records that are not available at the official BDM Registry, (and some in the official BDM that are not in the Districts). The information may be hand copied, but no photocopying is permitted without the Registrar's permission. Firstly search the District Indexes. (Note: the Book & Page certificate numbers are not the same as the numbers of the Principal Registrar's BDM indexes.) See location ②

## **Cemetery Records**

This material includes transcripts of headstones, memorials and burial registers. Many country cemeteries and lone graves are stored in a database on the library computers at ⑨ (this is an on-going project). Those cemeteries not yet computerized may be found in the cemetery folders (sorted by cemetery) or on cards (by surname). See location ③. Some burial registers (see Library Catalogue) are on microfiche at location ②

## **Shipping**

There are various indexes available, some with a key either at the back or in another volume. See location ④

- Passengers 1836–1845 (dark blue book)
- Passengers 1847–1886 (3 brown books) (the lists are on microfiche at location ②.)
- Passengers listed in newspapers 1846–1887 (red books)
- Passengers 1888–1908 (microfiche)
- Passengers 1909–1924 (on computer)
- Passengers 1925–1956 (5 black books)
- Ships Deserters 1852–1952

*Free Passage to Paradise?* compiled by Pat Button re free migrant labourers 1836–1841

Index to ships arriving in SA from overseas 1836–1900 (black book)

## **Genealogical Research Directories (GRD)**

A new volume published each year containing listing of surnames being researched and the contact person at location ③. Past commercial directories are at location ⑤.

## **Advertiser Personal Notices**

Pages from the *Advertiser* have been kept since the end of 1974 in bound volumes. See location

## **Destitute Asylum & Adelaide Hospital Admissions**

Useful as the records often include name of ship of arrival and how long in colony. Relatives may be also named on some destitute records. See location ⑦

## **Library Catalogue**

All reference books, local & family histories, transcriptions, microfiche and microfilms are listed on the library catalogue on any library computer ⑨ as well as on the SAGHS webpage at [www.saghs.org.au](http://www.saghs.org.au). Shelf location is recorded. Use key words to assist search.

Maureen M Leadbeater 23 Dec 2003